

RGB - DMX

Fuse RGB mini is a small profile of 8mm width and tight LED spacing produces consistent color with no visible hotspots.



PRODUCT CODE	INSTALL	LED TYPE	*MAX RUN	VOLTAGE
TPLFS	I	RGB	MR	24

TPLFS = Fuse Tape
I = Indoor
RGB = RGB mixing
MR = Max Run
24 = 24V DC

RGB+W - DMX

A 4 Channel LED tape system featuring a 3-in1 RGB LED with a dedicated white chip for vibrant color output and true white CCT.

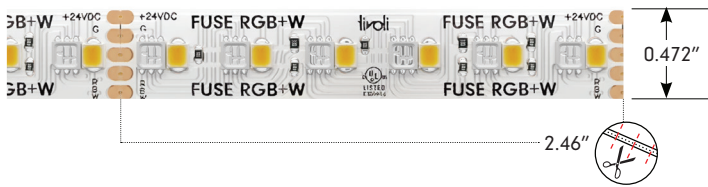

PRODUCT CODE	INSTALL	LED TYPE	*MAX RUN	VOLTAGE
TPLFS	I	RGB18 RGB22 RGB24 RGB27 RGB30 RGB35 RGB40 RGB50	MR	24

TPLFS = Fuse Tape
I = Indoor
RGB18 = RGB+1800K
RGB22 = RGB+2200K
RGB24 = RGB+2400K
RGB27 = RGB+2700K
RGB30 = RGB+3000K
RGB35 = RGB+3500K
RGB40 = RGB+4000K
RGB50 = RGB+5000K
MR = Max Run
24 = 24V DC

RGB+W+W - DMX

Fuse RGB+W+W is a dynamic RGB mixing with dynamic white CCT range all on one tape.

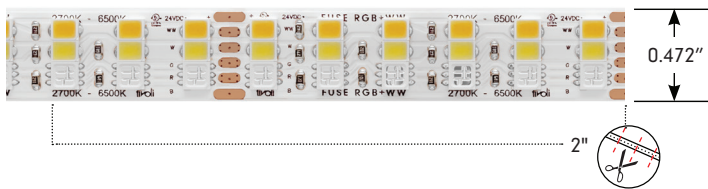

PRODUCT CODE	INSTALL	LED TYPE	LED WW COLOR	*MAX RUN	VOLTAGE
TPLFS	I	RGB	01	MR	24

TPLFS = Fuse Tape
I = Indoor
RGB = RGB mixing
01 = 27K-65K
MR = Max Run
24 = 24V DC

Quick Spec

Quick Data based on 4000K				
Color	Red	Green	Blue	RGB
Lumens/ft	54.9	166	44.4	254
Efficacy (Lm/W)	38	87	26	48
CRI	n/a	n/a	n/a	58
Measured Power W/ft	1.4	1.9	1.7	5.3
Listed Power W/ft.	4.4			
Max Run	17'			

ADUL-series					
SPI	D	DIN	DIN-X	DTV	VAOT
		*	*	*	

Non-Dimming (D), 0-10V (DOT), DMX (DIN), DMX Multi Address (DIN-X), Flicker Free TV (DTV), Dynamic White/0-10V (VAOT), SPI (SPI)



Available Color
Red, Green, Blue mixing

- IP67 Outdoor Rated Available
- Specify 4 conductor lead

Power Lead
TPL-I-LEAD-4-C
TPL-I-LEAD-4-D
TPL-I-XEP-4



Quick Spec

Output (based on RGB27)					
Color/Kelvin Temperature	Red	Green	Blue	RGB	RGB+27
Lumens/ft	45.6	119	31.3	193	370
Efficacy (Lm/W)	41	95	28	53	66
CRI	n/a	n/a	n/a	47.4	61.8
Wavelength	628	524	470	n/a	n/a
Measured Power W/ft	1.1	1.2	1.1	3.6	5.3
Listed Power W/ft.	5.3				
Max Run	17'				

ADUL-series					
SPI	D	DIN	DIN-X	DTV	VAOT
		*	*	*	

Non-Dimming (D), 0-10V (DOT), DMX (DIN), DMX Multi Address (DIN-X), Flicker Free TV (DTV), Dynamic White/0-10V (VAOT), SPI (SPI)



Available Color/CCTs
Red, Green, Blue, White

- 1800K, 2200K, 2400K, 2700K, 3000K, 3500K, 4000K, 5000K

- IP67 Outdoor Rated Available
- Specify 5 conductor lead

Power Lead
TPL-I-LEAD-5-C
TPL-I-LEAD-5-D
TPL-I-XEP-5



Quick Spec

Quick Data						
Color	Red	Green	Blue	RGB	2700K	6500K
Lumens/ft	24.8	80.1	22.1	126	202	239
Efficacy (Lm/W)	41	111	35	62	101	117
CRI	n/a	n/a	n/a	CF	98	94
Measured Power W/ft	0.60	0.72	0.62	2	2	2
Listed Power W/ft.	6					
Max Run	15'					

ADUL-series					
SPI	D	DIN	DIN-X	DTV	VAOT
		*	*	*	

Non-Dimming (D), 0-10V (DOT), DMX (DIN), DMX Multi Address (DIN-X), Flicker Free TV (DTV), Dynamic White/0-10V (VAOT), SPI (SPI)



Available Color/CCTs
Red, Green, Blue mixing

- Specify 6 conductor lead

Power Lead
TPL-I-LEAD-6-C
TPL-I-LEAD-6-D
TPL-I-XEP-6



Pixel24 RGB - DMX

24V DMX pixel controlled RGB LED tape for color changing effect with millions of colors to choose from. Boasting 3 pixel a foot.



PRODUCT CODE	VERSION	INSTALL	LED TYPE	*INSTALL	VOLTAGE
TPLFS	PX	I	RGB		24
TPLFS = Fuse Tape	PX = Pixel	I = Indoor	RGB = RGB mixing	MR = Max Run	24 = 24V DC

Pixel24 RGBW - DMX

24V DMX pixel controlled RGBW LED tape for color changing effect with millions of colors to choose from. Boasting 3 pixel a foot.



PRODUCT CODE	VERSION	INSTALL	LED TYPE	*INSTALL	VOLTAGE
TPLFS	PX	I	RGB27		24
TPLFS = Fuse Tape	PX = Pixel	I = Indoor	RGB27 = RGB+2700K RGB30 = RGB+3000K	MR = Max Run	24 = 24V DC

Pixel12 RGB - SPI

12V SPI protocol for precise pixel control of every LED at 0.66" spacing. Factory-applied 3M VHB adhesive, it ensures easy installation.

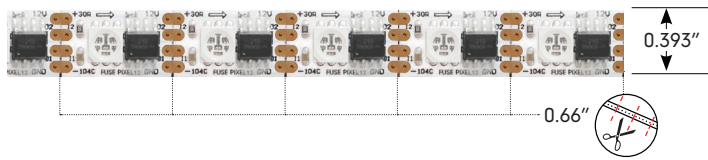

PRODUCT CODE	VERSION	INSTALL	LED TYPE	VOLTAGE
TPLFS	PX	I	RGB	12
TPLFS = Fuse Tape	PX = Pixel	I = Indoor	RGB = Red, Green, Blue Color Mixing	12 = 12V DC

Quick Spec



Quick Data				
Kelvin Temperature	Red	Green	Blue	RGB
Lumens/ft	44.7	126	36.4	207
Efficacy (lm/W)	26	74	21	52
CRI	n/a	n/a	n/a	n/a
Wavelength	630	525	470	630
Measured Power W/ft	1.7	1.7	1.7	4
Listed Power W/ft.	4.4			
Max Run	21'			

Available Color
Red, Green, Blue mixing

Specify 5 conductor lead

Power Lead
TPL-LEAD-5-C
TPL-LEAD-5-D
TPL-I-XEP-5



ADNM-series					
SPI	D	DIN	DIN-X	DTV	VAOT
	•				

Non-Dimming (D), 0-10V (DOT), DMX (DIN), DMX Multi Address (DIN-X), Flicker Free TV (DTV), Dynamic White/0-10V (VAOT), SPI (SPI)

Quick Spec



Output						
Kelvin Temperature	Red	Green	Blue	RGB	3000K	RGB+30
Lumens/ft	57.1	118	27.2	200	123	322
Efficacy (lm/W)	33	72	16	51	69	63
CRI	n/a	n/a	n/a	25	92.6	45.4
Wavelength	628	518	456	n/a	n/a	n/a
Measured Power W/ft	1.8	1.6	1.7	3.9	1.8	5.1
Listed Power W/ft.	5.1					
Max Run	18'					

Available Color/CCTs
Red, Green, Blue, White
2700K, 3000K,

Specify 5 conductor lead

Power Lead
TPL-LEAD-5-C
TPL-LEAD-5-D
TPL-I-XEP-5



ADNM-series					
SPI	D	DIN	DIN-X	DTV	VAOT
	•				

Non-Dimming (D), 0-10V (DOT), DMX (DIN), DMX Multi Address (DIN-X), Flicker Free TV (DTV), Dynamic White/0-10V (VAOT), SPI (SPI)

Quick Spec



Output (based on RGB27)				
Kelvin Temperature	Red	Green	Blue	All On
Lumens/ft	35.6	104	29.2	169
Efficacy (lm/W)	9	25	7	42
Wavelength	630	526	471	630
Measured Power W/ft	4.1	4.1	4.1	4
Listed Power W/ft.	3.66			
Max Run	20'			

Available Color
Red, Green, Blue mixing

Specify 5 conductor lead

Power Lead
TPL-LEAD-5-C
TPL-LEAD-5-D
TPL-I-XEP-5



ADUL-series					
SPI	D	DIN	DIN-X	DTV	VAOT
	•				

Non-Dimming (D), 0-10V (DOT), DMX (DIN), DMX Multi Address (DIN-X), Flicker Free TV (DTV), Dynamic White/0-10V (VAOT), SPI (SPI)

DW (Dynamic White) - DMX

Fuse DW seamlessly adjusts between two factory color range options, 1900K-3500K and 2700K-6500K for tailored illumination.

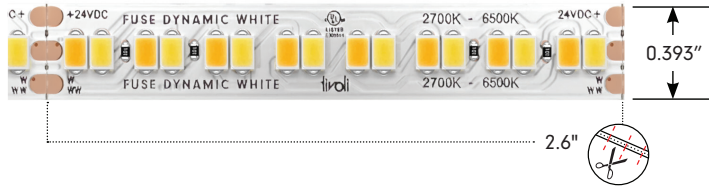

PRODUCT CODE	INSTALL	TYPE	LED COLOR	*MAX ROLL	VOLTAGE
TPLFS	I	DW	01		24
TPLFS = TivoTape Fuse	I = Indoor	DW = Dynamic White	01 = 1900K - 3500K 02 = 2700K - 6500K	*MR = MAX RUN	24 = 24V DC

Quick Spec



Quick Data						
Kelvin Temperature	19K	35K	All On	27K	65K	All On
Lumens/ft	284.3	404.3	686.7	409.4	440.2	840.8
Efficacy (Lm/W)	88.84	130.4	105.6	120.7	127.9	123.1
CRI	95.3	97.6	93.6	92.2	94.5	96.9
Measured Power W/ft	3.2	3.1	6.5	3.39	3.44	6.83
Listed Power W/ft.	3.50	3.50	7.0	3.50	3.50	7.0
Max Run	32'					

Available CCTs
1900K - 3500K
2700K - 6500K

Specify 3 conductor lead

Power Lead
TPL-LEAD-3-C
TPL-LEAD-3-D
TPL-I-XEP-3

ADUL-series					
SPI	D	DIN	DIN-X	DTV	VAOT
					*

Non-Dimming (D), 0-10V (DOT), DMX (DIN), DMX Multi Address (DIN-X), Flicker Free TV (DTV), Dynamic White/0-10V (VAOT), SPI (SPI)



In-Wall DMX Control

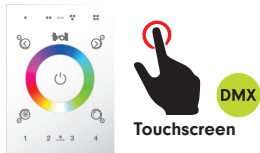

TVOQ-1-WH
White



TVOQ-10-XX-7
XX = BK (Black), WH (White)



TVOQ-2-BK
Black

Controls



ARTNET-S-8-512
8 port universe Artnet to DMX interface, 4096 DMX channels Programmable for playback and live support (Online or Offline option)



ARTNET-S-X-SPI
X = 4 (4 port), 8 (8 port)
Artnet to SPI interface. Programmable for playback and live support (Online or Offline option)

Network Hardware



ARTNET-L-XX-512
XX = 8, 16 (ports)
8 or 16 port universe Artnet to DMX interface, 16 port 8192 DMX channels, 8 port 4096 DMX channels



NTG-SWI-XXPT
XX = 8 (8 Port), 16 (16 Port)
NETGEAR 16-Port gigabit Unmanaged Switch



DMX3-CAT5-ADPTR
DMX adapter
3-pin XLR female to RJ45

MADRIX

MADRIX KEY

A USB dongle unlocks the software's full output. You can freely switch between different PCs as it is not bound to a specific one. It only needs to be activated online once.

MADRIX 5 LICENSE UPGRADES

You can easily upgrade your MADRIX 5 KEY to any higher license at any time, increasing the available output.

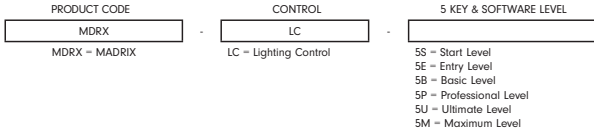

Level	START	ENTRY	BASIC		ULTIMATE	MAXIMUM
MADRIX 5 Order Code	MDRX-LC-5S	MDRX-LC-5E	MDRX-LC-5B	MDRX-LC-5P	MDRX-LC-5U	MDRX-LC-5M
DMX-Based Output						
DMX Channels	1,024	4,096	16,384	65,536	262,144	1,048,576
DMX Universe Example	2	8	32	128	512	2,048
RGB Voxels Example	341	1,365	5,461	21,845	87,381	349,525
DVI-Based Output						
DVI Voxels	4,096	16,384	262,144	1,048,576	2,097,152	2,097,152
Render Resolution (Pixel x Pixel)	64 x 64	128 x 128	512 x 512	1,024 x 1,024	2,048 x 1,024	2,048 x 1,024



Cue™ and CuePro™

Lighting control software packed with an array of tools required by the latest DMX lighting fixtures. Intuitive, with easy-to-use effects that can be dropped into timelines, and multi-zone synchronization capabilities allow you to program a project effortlessly.

Controls



DMX

MDRX-STELLA
MADRIX Art-Net node/USB 2.0 DMX512 interface, 2x DMX-In/Out, DIN rail



SPI DMX

MDRX-AURA-XX
X = 02, 08, 32 (ports)
MADRIX Luna 2, 8, 32 port universe Artnet to DMX interface. Programmable for playback and live support (Online or Offline option)



SPI

MDRX-NBLA-08
Up to 8 universes. SPI decoder receives control over ethernet network or USB delivering zero lag to your fixture

Network Hardware



DMX

MDRX-LUNA-XX
XX = 04, 08, 16 (ports)
MADRIX Luna 4, 8, 16 port universe Artnet to DMX interface 16 port 8192, 8 port 4096, 4 port 2048 DMX channels



SPI DMX

MDRX-ORION
MADRIX Art-Net/streaming ACN input unit, 8x analog inputs, RDM, DIN rail

Extrusion

Available Lens Type Compatible TivoTape

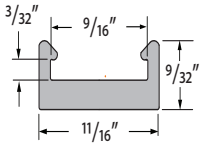

MCHAN-8-LP
Low profile NO LENS OPTION
clear polycarbonate, length 8'

RGB	RGBW	RGB+W+W	DW
Pixel24 RGBW	Pixel24 RGB	Pixel24 RGB	Pixel12 RGB

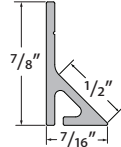

TPLI-45-MCH-8-S
White PVC, 45° NO LENS length 8'

RGB	RGBW	RGB+W+W	DW
Pixel24 RGBW	Pixel24 RGB	Pixel24 RGB	Pixel12 RGB

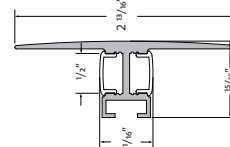

DWAR
DEWARE Anodized Aluminum Extrusion,
available in 6.5' lengths

Clear	Opal	Diffused	
RGB	RGBW	RGB+W+W	DW
Pixel24 RGBW	Pixel24 RGB	Pixel24 RGB	Pixel12 RGB

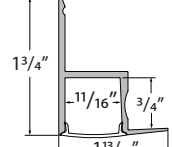

EDGE
EDGE Anodized Aluminum Extrusion,
available in 6.5' lengths

Opal			
RGB	RGBW	RGB+W+W	DW
Pixel24 RGBW	Pixel24 RGB	Pixel24 RGB	Pixel12 RGB

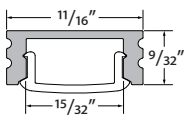

MINI
MINI Anodized Aluminum Extrusion,
available in 6.5' lengths

Opal			
RGB	RGBW	RGB+W+W	DW
Pixel24 RGBW	Pixel24 RGB	Pixel24 RGB	Pixel12 RGB

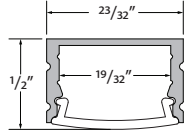

MOFT
MOFFETT Anodized Aluminum Extrusion,
available in 6.5' lengths

Clear	Opal	Diffused	
RGB	RGBW	RGB+W+W	DW
Pixel24 RGBW	Pixel24 RGB	Pixel24 RGB	Pixel12 RGB

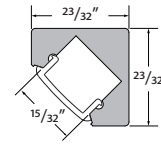

DYER
DYER Anodized Aluminum Extrusion,
available in 6.5' lengths

Opal			
RGB	RGBW	RGB+W+W	DW
Pixel24 RGBW	Pixel24 RGB	Pixel24 RGB	Pixel12 RGB

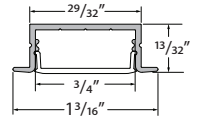

WRNR
WARNER Anodized Aluminum Extrusion,
available in 6.5' lengths

Opal			
RGB	RGBW	RGB+W+W	DW
Pixel24 RGBW	Pixel24 RGB	Pixel24 RGB	Pixel12 RGB

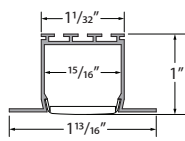

NOYES
NOYES Anodized Aluminum Extrusion,
available in 6.5' lengths

Clear	Opal	Diffused	
RGB	RGBW	RGB+W+W	DW
Pixel24 RGBW	Pixel24 RGB	Pixel24 RGB	Pixel12 RGB

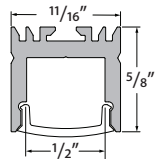

VALN
VALENCIA Anodized Aluminum Extrusion,
available in 6.5' lengths

Clear	Opal	Diffused	
RGB	RGBW	RGB+W+W	DW
Pixel24 RGBW	Pixel24 RGB	Pixel24 RGB	Pixel12 RGB

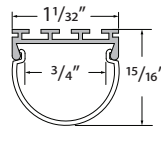

DOME
DOME Anodized Aluminum Extrusion,
available in 6.5' lengths

Opal			
RGB	RGBW	RGB+W+W	DW
Pixel24 RGBW	Pixel24 RGB	Pixel24 RGB	Pixel12 RGB

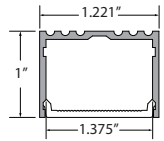

ALTON
ALTON Anodized Aluminum Extrusion,
available in 6.5' lengths

Clear	Opal	Diffused
RGB	DW	
Pixel12 RGB		

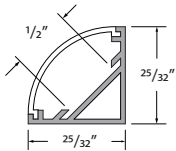

MRSAL
MARSALA Anodized aluminum extrusion
available in 6.5' length

Clear	Opal	Diffused
RGB	DW	
Pixel12 RGB		

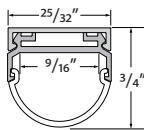

HRIZ
HORIZON Anodized aluminum extrusion
available in 6.5' length

Opal			
RGB	RGBW	RGB+W+W	DW
Pixel24 RGBW	Pixel24 RGB	Pixel24 RGB	Pixel12 RGB

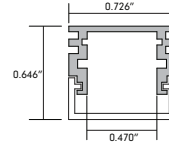

ASTRA
ASTORIA Anodized aluminum extrusion
available in 6.5' length

Clear	Diffused		
RGB	RGBW	RGB+W+W	DW
Pixel24 RGBW	Pixel24 RGB	Pixel24 RGB	Pixel12 RGB

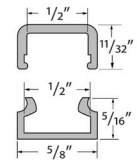

INF
INFINITY PC extrusion,
available in 8' lengths

Frosted	Diffused
RGB	DW
Pixel12 RGB	

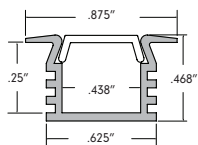

EDIN
EDINGER Anodized aluminum extrusion
available in 6.5' length

Opal	
RGB	DW
Pixel12 RGB	

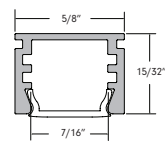

MOSR
MOSHER Anodized aluminum extrusion
available in 6.5' length

Opal	
RGB	DW
Pixel12 RGB	

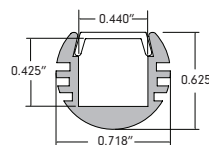

NOVA
NOVA Anodized aluminum extrusion
available in 6.5' length

Opal	
RGB	DW
Pixel12 RGB	

Power Supplies

RGB, RGBW, RGB+W+W

Dynamic White

Pixel12 RGB

ADUL/ADNM - DMX SINGLE ADDRESS

DESCRIPTION	CAT NO	APPLICATION	PRIMARY VOLTAGE	SECONDARY VOLTAGE	CIRCUIT BREAKERS	MAX LOAD	CIRCUIT CAPACITY
ADUL/ADNM Series Class 2 Transformer	ADNM-90-1-4-24-DIN	Indoor / Outdoor	100-277V AC 50/60 Hz	24V DC	1	90W	3.75A
	ADUL-120-1-4-24-DIN				1	96W	4A
	ADUL-240-2-4-24-DIN				2	2x96W	2x4A
	ADUL-320-3-4-24-DIN				3	3x96W	3x4A

ADUL - DMX MULTI ADDRESS

DESCRIPTION	CAT NO	APPLICATION	PRIMARY VOLTAGE	SECONDARY VOLTAGE	CIRCUIT BREAKERS	MAX LOAD	CIRCUIT CAPACITY
ADUL Series Class 2 Transformer	ADUL-240-2-4-24-DIN-2	Indoor / Outdoor	100-277V AC 50/60 Hz	24V DC	2	2x96W	2x4A
	ADUL-320-3-4-24-DIN-3				3	3x96W	3x4A

ADNM - DMX/DALI FLICKER-FREE FOR TV STUDIO

DESCRIPTION	CAT NO	APPLICATION	PRIMARY VOLTAGE	SECONDARY VOLTAGE	CIRCUIT BREAKERS	MAX LOAD	CIRCUIT CAPACITY
ADNM Series Class 2 Transformer	ADNM-120-1-4-24-DTV	Indoor / Outdoor	100-277V AC 50/60 HZ	24V DC	1	1x96W	1x4A
	ADNM-240-2-4-24-DTV				2	2x96W	2x4A
	ADNM-320-3-4-24-DTV				3	3x96W	3x4A

ADNM - DYNAMIC WHITE SINGLE CIRCUIT

DESCRIPTION	CAT NO	APPLICATION	PRIMARY VOLTAGE	SECONDARY VOLTAGE	CIRCUIT BREAKERS	MAX LOAD	CIRCUIT CAPACITY
ADNM Series Class 2 Transformer	ADNM-90-1-4-24-VAOT	INDOOR / OUTDOOR	100-277V AC 50/60 Hz	24V DC	1	90W	3.75A
	ADNM-120-1-4-24-VAOT				1	96W	4A

ADNM - DYNAMIC WHITE MULTI CIRCUIT

DESCRIPTION	CAT NO	APPLICATION	PRIMARY VOLTAGE	SECONDARY VOLTAGE	CIRCUIT BREAKERS	MAX LOAD	CIRCUIT CAPACITY
ADNM Series Class 2 Transformer	ADNM-240-2-4-24-VAOT	INDOOR / OUTDOOR	100-277V AC 50/60 Hz	24V DC	2	2x96W	2x4A
	ADNM-320-3-4-24-VAOT				3	3x96W	3x4A

ADUL - SPI CONTROL

DESCRIPTION	CAT NO	APPLICATION	PRIMARY VOLTAGE	SECONDARY VOLTAGE	CIRCUIT BREAKERS	MAX LOAD	CIRCUIT CAPACITY
ADUL Series Class 2 Transformer	ADUL-60-1-5-12-SPI	Indoor or Damp	100-277V AC 50/60 HZ	12V DC	1	60W	5A
	ADUL-150-2-5-12-SPI-2				2	2x60W	2x5A
	ADUL-240-3-5-12-SPI-3				3	3x60W	3x5A
	ADUL-320-4-5-12-SPI-4				4	4x60W	4x5A

Power Supplies

Pixel24 RGB, Pixel24 RGBW

ADUL/ADNM - NON DIMMING

DESCRIPTION	CAT NO	APPLICATION	PRIMARY VOLTAGE	SECONDARY VOLTAGE	CIRCUIT BREAKERS	MAX LOAD	CIRCUIT CAPACITY
ADUL/ADNM Series Class 2 Transformer	ADNM-90-1-4-24-D	Indoor / Outdoor	100-277V AC 50/60 HZ	24V DC	1	90W	3.75A
	ADUL-120-1-4-24-D				1	96W	4A
	ADUL-240-2-4-24-D				2	2x96W	2x4A
	ADUL-320-3-4-24-D				3	3x96W	3x4A

INFINITY - MLV / ELV / 0-10V / PWM / TRIAC

DESCRIPTION	CAT NO	APPLICATION	PRIMARY VOLTAGE	SECONDARY VOLTAGE	CIRCUIT BREAKERS	MAX LOAD	MIN LOAD	CIRCUIT CAPACITY
Infinity Series Class 2 Transformer	INF-J-30-1-1.3-24	Indoor / Outdoor	100 - 277V AC	24V DC	1	30W	3W	1.3A
	INF-J-60-1-2.5-24				1	60W	6W	2.5A
	INF-J-96-1-4-24				1	96W	9W	4A
	INF-J-192-2-4-24				2	2x96W	2x9W	2x4A
	INF-J-288-3-4-24				3	3x96W	3X9W	3x4A

Dimmers

DIMMING - 0-10V

DESCRIPTION	CAT NO	APPLICATION	INPUT VOLTAGE	OUTPUT VOLTAGE	MAX LOAD
0-10V Dimmer	DIM-LD-010	Indoor	12V/24V DC	12V/24V DC	30 mA max. output (sink only)

DIMMING -MLV

DESCRIPTION	CAT NO	APPLICATION	INPUT VOLTAGE	OUTPUT VOLTAGE	MAX LOAD
MLV Dimmer	N-600	Indoor	120V AC	120V AC	450W
	N-1000				800W
	N-1500				1200W
	D-600				450W
	M-600				450W
	M-1000				800W

DIMMING - ELV

DESCRIPTION	CAT NO	APPLICATION	INPUT VOLTAGE	OUTPUT VOLTAGE	MAX LOAD
ELV Dimmer	ME-600	Indoor	120V AC	120V AC	450W
	DE-300				300W